

Dilution Control Systems

Sink Station Model #421070

■ OPERATION ■ SERVICE ■ PARTS ■ CARE

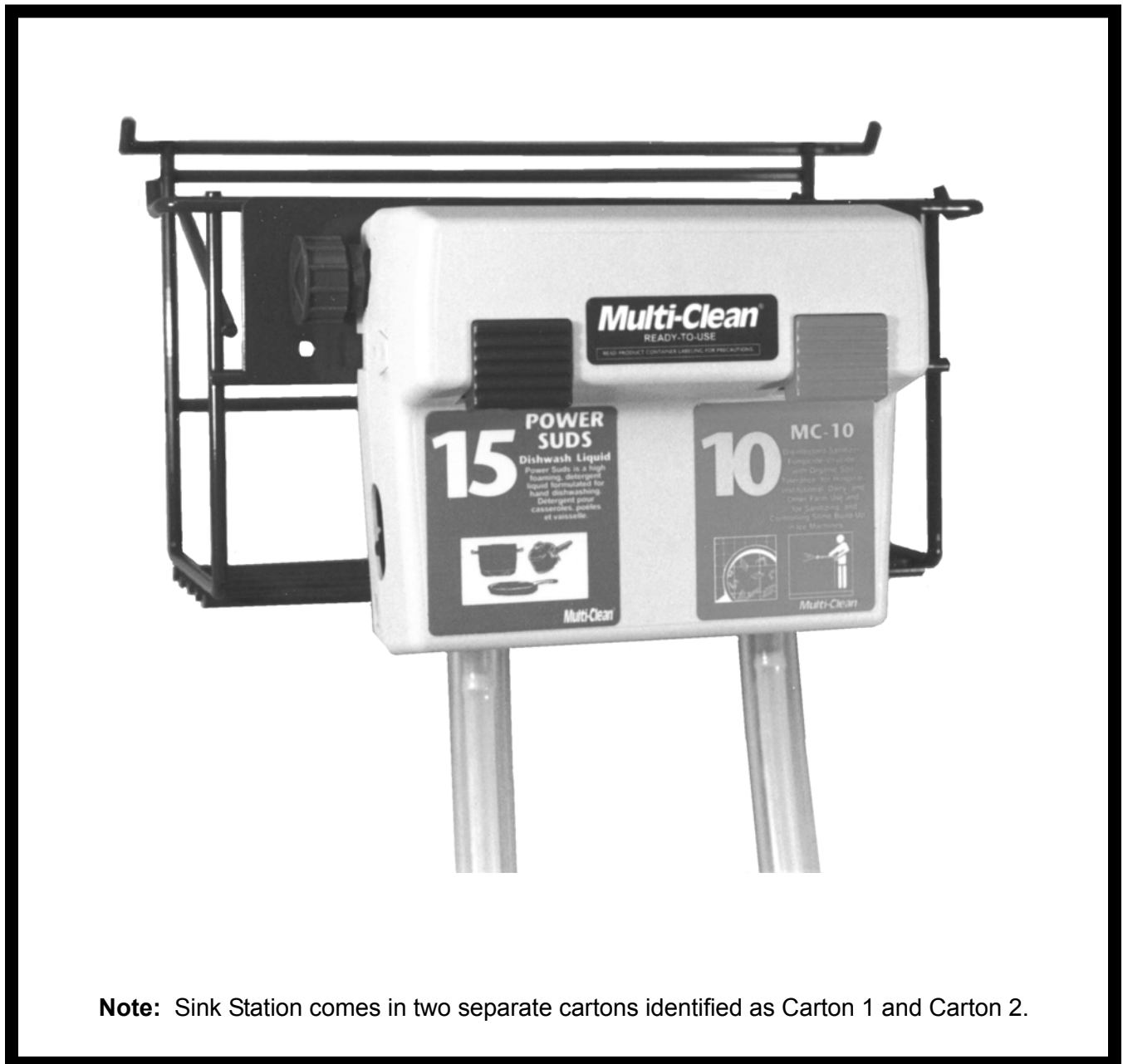

Multi-Clean®

Single Station #421070

Installation:

1. Mount the 2-Button Dispenser to the front of the wire rack using the stainless steel bolts and nuts provided. Optional: The 2-Button Dispenser may be directly wall mounted if desired.
2. Mount the rack over the 3-basin sink. Screws and anchors are supplied for wall mounting into solid walls.

For hollow walls, a hollow wall butterfly anchor is needed capable of supporting up to 25 lbs. (determine wall thickness to obtain correct butterfly anchor).

Hold rack to the wall and mark 2 hole locations through the 2 horizontal mounting bars near the top of the rack. Drill holes with a 1/4" bit, insert anchors, then screw rack into wall.

3. Place Power Suds and MC-10 Sanitizer in rack or in convenient location.
4. Remove cabinet cover. Install the short, white inner discharge tube (B) on the bottom of the eductor (A). This tube must be in place for the eductor to function. Install the end of the tube nearest the flooding ring on the eductor's inner discharge barb.
5. A 4 ft. discharge hose (C) is supplied. Slide end of hose over discharge outlet on bottom of eductor (A).
6. Slip hose end of each cap hose assembly (E) over black inlet barb (D).
7. Replace cabinet cover. Push the sides in, behind the latch holes, to snap the cover in place. The two screws provided may be installed in the holes in the cabinet sides to prevent easy removal of cover.
8. Screw cap/hose assembly onto appropriate Super Concentrate. Position the Super Concentrate, with color coded buttons and labels.
9. Attach water supply hose to 2-Button Dispenser.

Operation:

1. Turn on water to pressurize the unit.
2. Each color coded button has an optional locking mechanism that can be utilized by breaking the 2 tabs off on the underside of each button. (See illustration).
3. To dispense Power Suds Dish Wash Detergent or MC-10 Sanitizer, simply depress the appropriate color coded button until the desired fill level is reached in the sink. When the locking button option is used, simply push the button in when fill level is reached and the button will release.

Optional Accessory Kits available to allow the water output to be adjusted to any suitable temperature.

1. Quick Disconnect for Male Threaded Faucets #421072.
2. Sink Kit for Overhead Rinse Arm Set-up #421074.
3. Sink Kit for Standard Faucet (Fischer, Chicago, T&S) #421076.

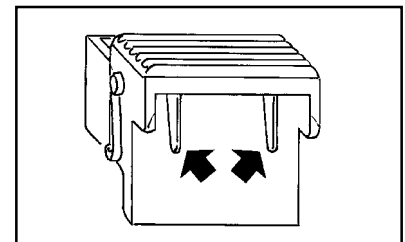
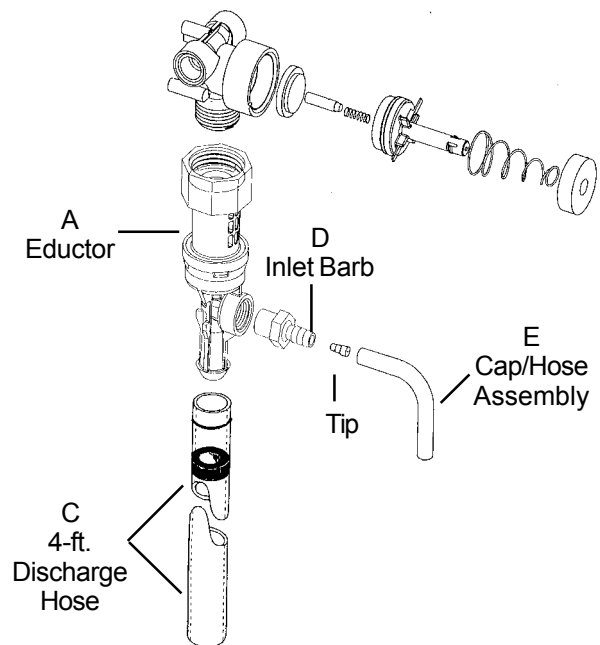

Clip or bend these tabs to depress button into locked position.

Metering Tip Selection:

The final concentration of the dispensed liquid is related to both the size of the metering tip opening and the viscosity of the liquid being siphoned. Such factors as inlet water pressure and temperature can affect dilution ratios. Test the actual dilution you are dispensing using the Measurement of Concentration procedure or the Calibration Kit.

1. Install the concentrate feed tube as follows:
 - Push the other (open) end of the Quick Connect Cap/Hose assembly over the hose barb on the Air Gap.
 - Remove cap on concentrate, then place the Quick Connect Cap/Hose Assembly onto the concentrate container and screw on.
2. Apply color-coded label under the button to correspond to the product that will be dispensed when depressing that button.
3. Purge air from the system by depressing the buttons briefly. There may be some water discharge from the Air Gap vents until the air is purged.
4. Push button to start flow of desired water/concentrate solution, and hold until solution starts to be discharged. (Be sure to have a bottle or other receptacle under the discharge tube.) Prime each of the supply tubes in this way. Then push the button whenever dispensing is desired, and release button to stop flow of solution.
5. **It is essential that the discharge hose not be obstructed. If discharge is restricted, water will flow out the Air Gap vents. Do not start to operate the dispenser with liquid in the discharge tube.**

Measurement of Concentration:

To determine the dispensed water-to-product ratio for any metering tip size, operate the primed dispenser for a minute or so and note the amount of dispensed solution, and the amount of concentrate used in preparation of the solution. These values can be placed in the equation below to determine the achieved dilution ratio. Dilution Ratio equals X parts water to one part concentrate (X:1).

$$\text{Dilution Ratio (X:1) where } X = \frac{\text{Amount of Mixed Solution} - \text{Amount of Concentrate Drawn}}{\text{Amount of Concentrate Drawn}}$$

Multi-Clean has a calibration kit to make this easier. Consult your dealer representative for more information.

RECOMMENDED TIPS FOR USE WITH MULTI-CLEAN SUPER CONCENTRATES

Product	1 GPM Fill Rate				4 GPM Fill Rate			
	Heavy Cleaning Dilution	Tip Color	Normal Cleaning Dilution	Tip Color	Heavy Cleaning Dilution	Tip Color	Normal Cleaning Dilution	Tip Color
#64 Ful-Trole	NA	NA	1:64	Aqua	NA	NA	1:64	Green
#2 Glass & Surface Cleaner	NA	NA	1:20	Green	NA	NA	1:20	White
#3 Soap Scum Remover	1:20	Green	1:32	Brown	1:20	White	1:32	Tan
#4 F.A.S.T. (Foaming Acid Shower Treatment)	1:20	Green	1:32	Brown	1:20	White	1:32	Tan
#5 Neutral Cleaner	1:128	Purple	NA	NA	1:128	Yellow	1:256	Pink
#6 A.P.C. (All Purpose Cleaner)	1:64	Aqua	1:150	Purple	1:64	Green	1:150	Aqua
#7 X-Stream Surface Cleaner	1:4	Black	1:6	Beige	1:4	Gray	1:6	Black
#8 Super-D Degreaser	1:32	Brown	1:50	Yellow	1:32	Tan	1:50	Green
#9 R ² Stripper	NA	NA	NA	NA	NA	NA	1:8	Beige
#10 MC-10 Sanitizer	NA	NA	NA	NA	1:160	Purple	1:512	*Olive Green
#11 Odor Control	1:20	Green	1:64	Aqua	1:20	White	1:64	Green
#12 Foaming F.S.D.	1:20	Green	1:32	Brown	1:20	White	1:32	Tan
#13 Extraction Cleaner	NA	NA	NA	NA	NA	NA	1:256	Pink
#14 Carpet Spotter & Pre-Spray	1:5 (spotter)	Beige	1:32 (pre-spray)	Brown	1:5 (spotter)	Black	1:32 (pre-spray)	Tan
#15 Power Suds	1:128	Aqua	1:256	Purple	1:128	Green	1:256	Purple
#256 Century Q	1:64 (toilet bowls)	Aqua	1:256	Pink	1:64	Green	1:256	Pink
#257 P.H.D.	1:64	Yellow	1:256	Pink	1:64	Blue	1:256	Aqua

THANK YOU FOR YOUR INTEREST IN OUR PRODUCTS

Please use this equipment carefully and observe all warnings and cautions.

***** NOTE *****

WEAR	protective clothing and eyewear when dispensing chemicals or other materials.
ALWAYS	observe safety and handling instructions
ALWAYS	direct discharge away from you or other persons or into approved containers.
ALWAYS	dispense cleaners and chemicals in accordance with instructions. Exercise CAUTION when maintaining your equipment.
KEEP	equipment clean to maintain proper operation.
WEAR	protective clothing and eyewear when working in the vicinity of all chemicals filling or emptying equipment or changing metering tips.
ALWAYS	re-assemble equipment according to instruction procedures. Be sure all components are firmly screwed or latched into position.
ATTACH	only to tap water outlets (85 PSI maximum).

TROUBLESHOOTING CHART:

Problem	Cause	Solution
1. No discharge	<ul style="list-style-type: none"> a. No water b. Magnetic valve not functioning c. Excessive water pressure d. Air gap clogged 	<ul style="list-style-type: none"> a. Open water supply b. Install valve parts kit c. Install regulator if flowing water pressure exceeds 60 PSI d. Clean* or replace
2. No concentrate draw	<ul style="list-style-type: none"> a. Clogged foot valve b. Metering tip or Air gap has scale build-up c. Low water pressure d. Discharge tube and/or flooding ring not in place e. Concentrate container empty f. Inlet hose barb not screwed into Air gap tightly g. Clogged water inlet strainer 	<ul style="list-style-type: none"> a. Clean or replace b. Clean (descale)* or replace c. Minimum 25 PSI (with water running) required to operate unit properly d. Push tube firmly onto eductor discharge hose barb, or replace tube if it doesn't have a flooding ring e. Replace with full container f. Tighten, but do not overtighten g. Disconnect inlet water line and clean strainer
3. Excess concentrate draw	<ul style="list-style-type: none"> a. Metering tip not in place 	<ul style="list-style-type: none"> a. Press correct tip firmly into barb on eductor
4. Failure of unit to turn off	<ul style="list-style-type: none"> a. Water valve parts dirty or defective b. Magnet doesn't fully return c. Push button stuck d. Excessive water pressure 	<ul style="list-style-type: none"> a. Clean* or replace with valve parts kit b. Make sure magnet moves freely. Replace spring if short or weak c. Realign cabinet or clean grommet that button passes through d. Install regulator if pressure (with water flowing) exceeds 60 PSI
5. Excess foaming in discharge	<ul style="list-style-type: none"> a. Air leak in pick-up tube b. Inner discharge tube not in place 	<ul style="list-style-type: none"> a. Put clamp on tube or replace tube if brittle b. Install inner discharge tube
6. Water discharge from air	<ul style="list-style-type: none"> a. Restricted discharge hose vents of Air Gap b. High water pressure 	<ul style="list-style-type: none"> a. Be sure discharge hose is not immersed, kinked or elevated. Be sure there is no liquid in the discharge hose when beginning to operate dispenser b. Install pressure regulator if flowing water pressure exceeds 60 PSI

* In hard water areas, scale may form inside the discharge end of the Air Gap, as well as in other areas of the unit that are exposed to water. This scale may be removed by soaking the Air Gap in a descaling solution (deliming solution). To remove an Air Gap located in the cabinet, firmly grasp valve and unthread Air Gap. Replace in same manner. Alternatively, a scaled Air Gap can be cleaned (or kept from scaling) by drawing the descaling solution through the unit. Operate the unit with the suction tube in the descaling solution. Operate the unit until solution is drawn consistently, then flush the unit by drawing clear water through it for a minute. Replace concentrate container and put suction tube into concentrate.

LIMITED WARRANTY

Multi-Clean Division warrants to the original purchaser/user that this product is free from defects in workmanship and materials under normal use and service for a period of 90 days from date of purchase. In addition, Multi-Clean Division will, at its option, honor labor warranty claims for the first 90 days from date of sale, provided such claims are submitted through and approved by factory authorized repair stations. Multi-Clean Division will, at its option, repair or replace without charge, except for transportation costs, parts that fail under normal use and service when operated and maintained in accordance with the applicable operation and instruction manuals.

This warranty does not apply to normal wear, or to items whose life is dependent on their use and care, such as belts, cords, switches, hoses, rubber parts, electrical motor components or adjustments. Parts not manufactured by Multi-Clean Division such as engines, batteries, battery chargers, hydraulic pumps, and tires are covered by and subject to the warranties and/or guarantees of their manufacturers. Please contact Multi-Clean Division for procedures in warranty claims against these manufacturers.

Special warning to purchaser — A potential health hazard exists without exact original equipment replacement.

All warranted items become the sole property of Multi-Clean Division or its original manufacturer, whichever the case may be.

Multi-Clean Division disclaims any implied warranty, including the warranty of merchantability and the warranty of fitness for a particular purpose. Multi-Clean Division assumes no responsibility for any special, incidental or consequential damages.

This limited warranty is applicable only in the U.S.A. and Canada, and is extended only to the original user/purchaser of this product. Customers outside the U.S.A. and Canada should contact their local distributor for export warranty policies. Multi-Clean Division is not responsible for costs or repairs performed by persons other than those specifically authorized by Multi-Clean Division. This warranty does not apply to damage from transportation, alterations by unauthorized persons, misuse or abuse of the equipment, use of non-compatible chemicals, or damage to property, or loss of income due to malfunctions of the product.

If a difficulty develops with this machine, you should contact the dealer from whom it was purchased.

This warranty gives you specific legal rights, and you may have other rights which vary from state to state. Some states do not allow the exclusion or limitation of special, incidental or consequential damages, or limitations on how long an implied warranty lasts, so the above exclusions and limitations may not apply to you.

Multi-Clean[®]

600 Cardigan Road, Shoreview, Minnesota 55126 USA • Phone (651) 481-1900 Fax (651) 481-9987
2210 Drew Road, Mississauga, Ontario Canada L5S 1B1 • Phone (905) 673-3222 Fax (905) 673-5161

988363
Printed in U.S.A.